

Somfy Automation

Sunis RTS Sensor Programming

Charging the sensor



Before programming the sensor, remove it from the packaging and place it in direct sunlight with the solar panel up for a minimum of 20 minutes.

Recording the sensor into the motor memory

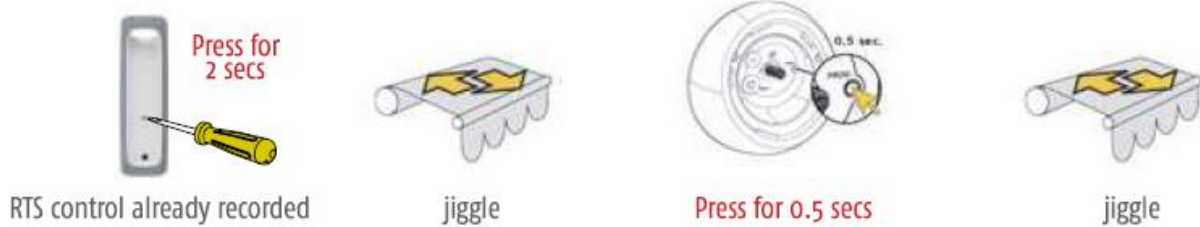

Commissioning the sensor

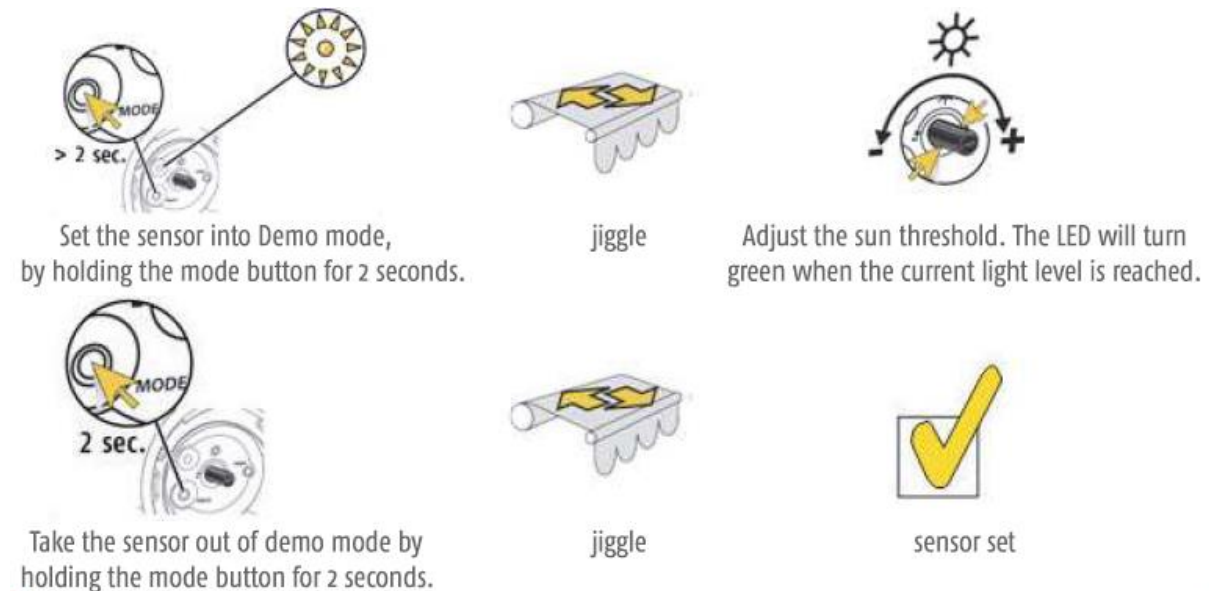

An awning will automatically extend to the intermediate position when controlled by the sensor (if a "MY" position has been set). If an intermediate position has not been set, the awning will fully extend.

When a sensor is recorded into the memory of a motor, it regularly sends a security signal to confirm radio communication. If the sensor is faulty or damaged, the motor will not receive the signal and the awning will retract. Remember to delete the sensor from the motor memory if the sensor is to be removed from the installation.

Flowchart for Sunis RTS Sensor Programming

IMPORTANT NOTE:
 This procedure will only work if you have an existing remote that has already been programmed to the motor.

