

Somfy Automation

Programming Eolis 3D RTS Sensor

Programming the Sensor into the Motor Memory

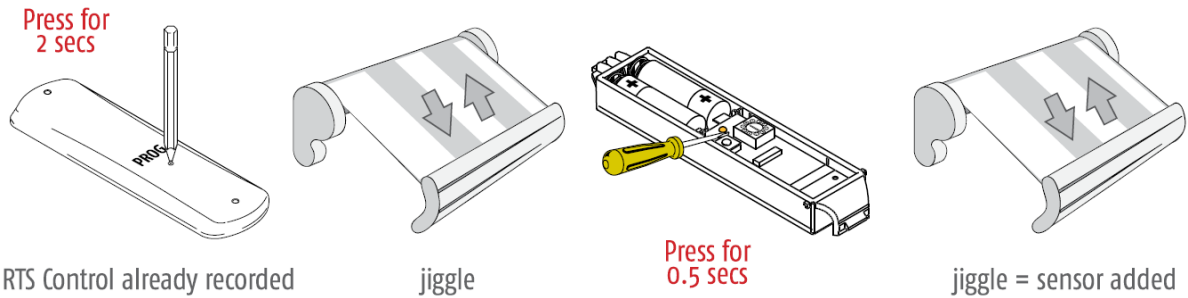

Adjusting Sensitivity

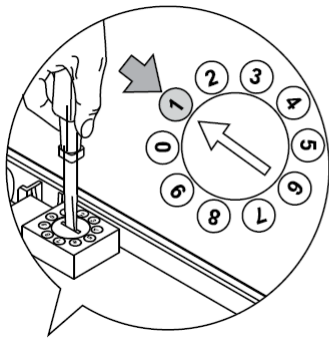

Set the motion threshold adjuster to between 3-6.

Note: Setting to '0' will put the sensor into a learning mode. Refer to the installation guide for more details.

Test the Sensor

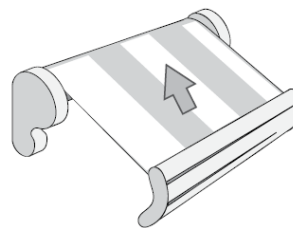
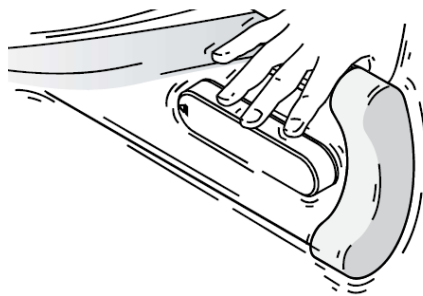

sensor added

Test the sensor functionality by shaking the awning.
The awning should retract if the sensor has been programmed correctly.

Somfy Tip: Removing, then replacing batteries after changing settings is recommended. Make sure the UP button retracts and DOWN button projects the awning, otherwise you need to reset the awning.

Flowchart for Sensor Programming

