

RTS Motor Hardwired

Procedure to Replace Lost or Damaged RTS Control

Note: This procedure will only delete previously programmed remotes & program in the remote that has been pressed. RTS Sensors will not be deleted.

Perform a Double Power Cut with Time Delays

Complete a 2 - 10 - 2 process.

Start with the power On then complete the following steps:

1. **TURN POWER OFF** for 2 seconds
2. **TURN POWER ON** for 10 seconds
3. **TURN POWER OFF** for 2 seconds
4. **TURN POWER ON**

The product will move up or down. If the product does not move, then you may need to leave the product for 5 - 10 mins and try again

Complete Factory Reset with Remote Control

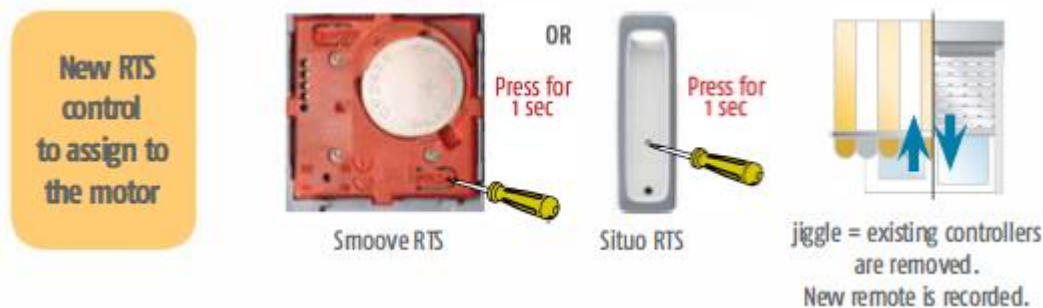

Flowchart for Replacing Lost or Damaged RTS Control

