

Altus 28 WF Li-ion RTS

Adjusting the Motor Speed

Note: The motors default speed is 20 rpm. The motor speed range is 10-28 rpm, changing with increments of 2 rpm. The motor will no longer jiggle once the maximum or minimum speed has been reached.

Motor Speed Setting

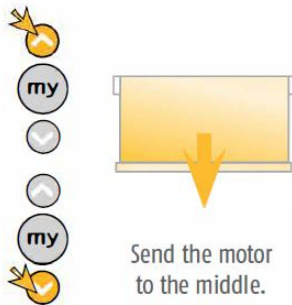

Send the motor to the middle.



Press and hold Up, **my** and Down buttons until the motor jiggles.

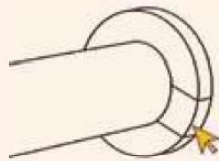

Green and yellow LED begins flashing alternately.



The motor will continually travel up and down.
To increase the speed continue to step 2.
To decrease the speed move to step 3.

Increase Motor Speed



Hold the Up button until the motor jiggles.
Repeat the process to further increase speed.

Decrease Motor Speed

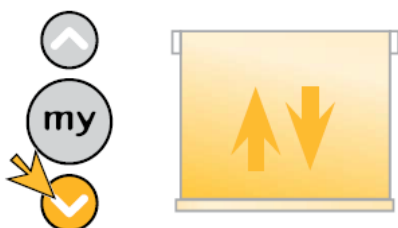

Hold the Down button until the motor jiggles.
Repeat the process to further decrease speed.

Save New Motor Speed



Hold the **my** button until the motor jiggles.

Flowchart for Adjusting the Motor Speed

